

CLEANING INSTRUCTIONS

1.) **SPIKE REMOVAL:** Remove any attachments from the bottle mount and place the Spike Removal Tool (A) between the bottle mount and the top flange of the spike (B) as shown. Press the tool firmly until the spike "pops" out. Spike and contents (pictured in step 4) should be washed in hot soapy water then rinsed. Use the brush supplied in the cleaning kit to remove contaminants from spike.

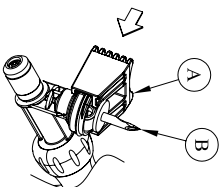

2.) **BARREL REMOVAL:** Unscrew the needle nut (C) from the barrel (D). Next, unscrew the barrel collar (E) to remove entire barrel from vaccinator. Wash the all parts in hot, soapy water, then rinse. Use the supplied brush to remove any remaining contaminants from barrel.

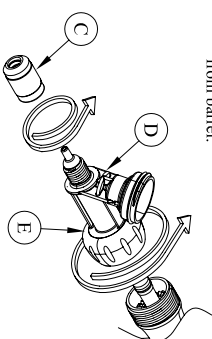

3.) **HANDLE CLEANING:** At this point the remaining handle assembly (G) should be washed or allowed to soak in hot soapy water, then rinsed and allowed to dry. Before reinstalling the barrel assembly, apply 1 or 2 drops of food-grade lubricant to the piston o-ring (F).

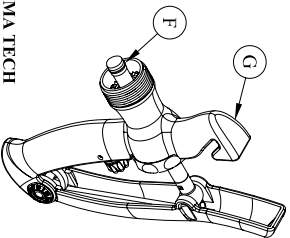

4.) **REASSEMBLY:** Reinstall the needle nut onto the barrel and reinstall barrel onto handle assembly. Place 1 drop of lubricant on the internal o-ring (H) and replace into the recessed area in the bottom of the spike. Next, replace valve spring (I) into bottle mount and apply 1 drop of lubricant. This spring is conical in shape. The small end must go up. Next, place check ball (J) on top of spring and re-install spike. Push in firmly until it snaps.

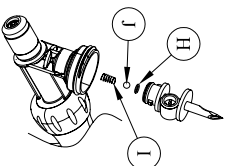

!!CAUTION!! DO NOT OVER TIGHTEN NEEDLE NUT! FINGER TIGHTEN ONLY! OVERTIGHTENING CAN CAUSE BARREL BREAKAGE! DO NOT PLACE ANY PART OF THE VACCINATOR IN A MICROWAVE OVEN OR NEAR A HEAT SOURCE!

***PRIMA TECH
CLEANING KIT
PART# 340849 ***

To learn more about these and other quality Prima Tech, USA product lines, please visit our website at www.primatechusa.com or call 910-296-6116.

PRIMA MARC
0-2ml & 0-6ml
Capacities

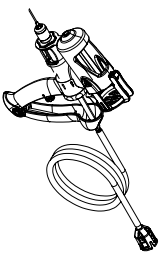

PRIMA MARC-BMV
0-2ml & 0-6ml
Capacities

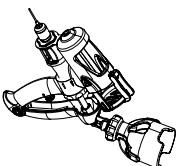

PRIMA REPEATER
0-2ml, Change Capacity
.1ml, .2ml mechanical increments

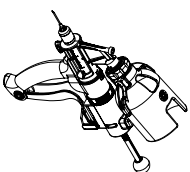

VACCINATOR
0-2ml & 0-6ml
Capacities

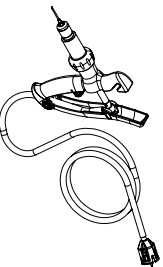

INJECTOR
0-12.5ml Capacity
.5ml increments

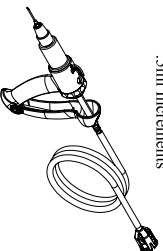

POUR-ON
0-50ml & 0-70ml Capacities

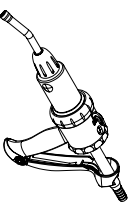

Prima Tech instruction form #338648-A

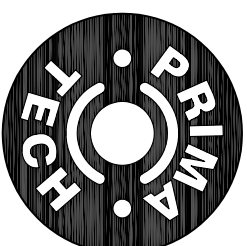

Prima Tech USA
P.O. Box 336
277 Faison McGowan Rd.
Kenansville, NC 28349
910-296-6116
www.primatechusa.com

INSTRUCTION MANUAL BMV (BOTTLE-MOUNT VACCINATOR)

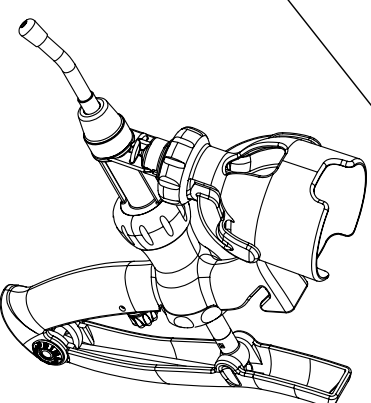
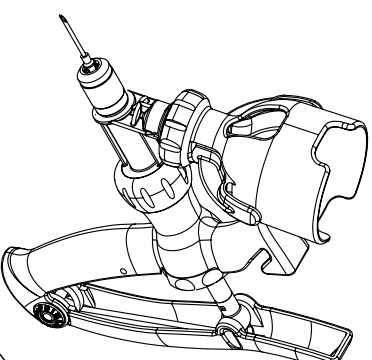

INSTRUCTIONS FOR USE

TO FIT NEEDLE WITH METAL LEUR NEEDLE NUT:

*Some units are equipped with a plastic "T"-slot type needle nut. If your vaccinator has this type of needle nut, please use the instructions under the next section.

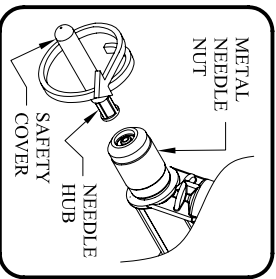
- 
- 1.) For safety, leave protective cover on needle until ready to prime vaccinator.
 - 2.) Make sure metal needle nut is finger tight. DO NOT TIGHTEN WITH PLIERS OR OTHER TOOLS. THIS CAN CAUSE BARREL BREAKAGE.
 - 3.) Push needle hub into needle nut and twist clockwise until needle locks in place. Remove safety cover when ready to prime vaccinator by continuing to twist clockwise. The safety cover will twist off, exposing the needle. (KEEP COVER FOR NEEDLE REMOVAL.)
 - 4.) To remove needle. Replace safety cover onto needle and twist counter-clockwise. Needle will twist out. Discard needle in bio-safe container. DO NOT REMOVE NEEDLE NUT TO REMOVE NEEDLE. THE NEEDLE NUT WILL STAY IN PLACE.

TO FIT NEEDLE WITH PLASTIC NEEDLE NUT:

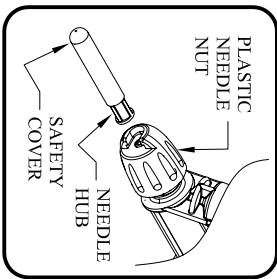
- 
- 1.) For safety leave protective cover on needle until ready to prime vaccinator.
 - 2.) Loosen plastic needle nut until nib is below cut-out "T"-slot section as shown.
 - 3.) Insert needle base into cut-out "T"-slot section and screw needle nut firmly onto barrel. DO NOT TIGHTEN WITH PLIERS OR OTHER TOOLS. THIS CAN CAUSE BARREL BREAKAGE.
 - 4.) Remove safety cover when ready to prime vaccinator by twisting safety cover clockwise. The safety cover will twist off, exposing the needle.
 - 5.) To remove needle. Replace safety cover onto needle. Partially unscrew needle nut until needle can be removed. Discard needle in bio-safe container.

TO ASSEMBLE/CLEAN DRENCHER NOZZLE:

* Some vaccinating units are equipped with a removable nozzle for drenching applications. These units are not supplied with a needle nut, but a drench nozzle only. If your unit is so equipped, please use the cleaning and assembly instructions below.

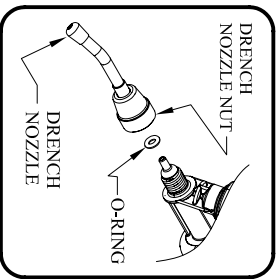
- 
- 1.) To remove the drencher for cleaning, unscrew the drench nozzle nut from the barrel.
 - 2.) Inside, you will find a small o-ring. The o-ring should stay in place, but can fall out. Take care not to lose the o-ring.
 - 3.) After cleaning with hot soapy water & rinsing, apply a small drop of food-grade lubricant (provided in the Prima Tech cleaning kit) to the o-ring to prevent dry rot and keep it in place.
 - 4.) Make sure o-ring is in place and screw the drench nozzle nut back onto the vaccinator. HAND-TIGHTEN ONLY. DO NOT TIGHTEN WITH PLIERS OR OTHER TOOLS. THIS CAN CAUSE BARREL BREAKAGE.

TO PUNCTURE RUBBER STOPPER (BUNG):

*Before mounting bottle to vaccinator, the rubber stopper can be punctured by using the handle spring puncturing feature. It is recommended that the puncturing tip be sterilized with alcohol first.

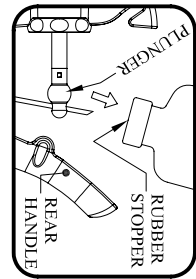
- 
- 1.) Open the rear handle of the vaccinator to expose the handle spring as shown.
 - 2.) Remove the tear-off cap from the bottle, exposing the rubber stopper.
 - 3.) The handle spring end is angled. Push firmly into the rubber stopper until it punctures.
 - 4.) Close the rear vaccinator handle and press firmly until it snaps back onto the plunger.

TO OPERATE FAST FIT BOTTLE MOUNT:

* Some vaccinating units are equipped with a fast-fit bottle adapter. There are 2 sizes of fast-fit adapters. There is a fast fit adapter for 100ml bottles, and another for 250ml bottles. If your unit is so equipped, please use the bottle changing instructions below.

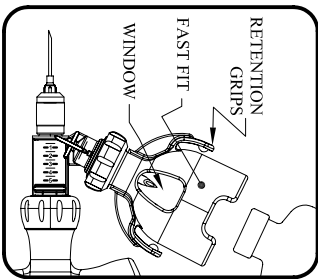
- 
- 1.) TO ATTACH BOTTLE:
 - A.) After piercing rubber stopper, hold bottle at base in one hand and hold vaccinator with the other.
 - B.) Looking through the fast fit window, align pierced rubber stopper with vaccinator draw spike and press firmly together. *DO NOT TWIST BOTTLE!*
 - 2.) TO REMOVE BOTTLE:
 - A.) Using the thumb and forefinger of one hand, squeeze the retention grips firmly together.
 - B.) Using the other hand, grasp the bottle by the bottom and pull firmly out of the fast fit.

TO ATTACH BOTTLE USING BOTTLE COLLARS:

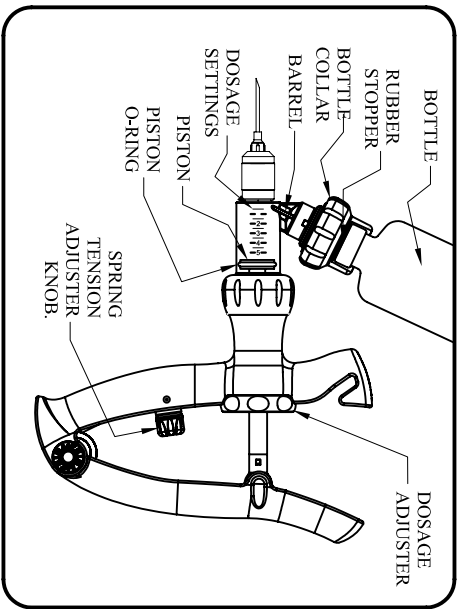

* Some units are equipped with spike collars. There are 3 sizes of spike collars. There is a collar for 100ml bottles (20mm), another for 250ml bottles (30mm), and a third for bottles with a 33mm diameter cap. Vaccinators may be supplied with any combination of the three. However, operation instructions are the same for each.

- 1.) Completely unscrew the spike collar from the barrel and remove spike cover.
- 2.) Insert the bottle neck into the "T"-slot cut-out area of the spike collar.
- 3.) Hold bottle with assembled spike collar in one hand, while pushing the draw spike through the hole already pierced in the rubber stopper.
- 4.) Hold firmly to vaccinator & screw-on the spike collar.

TO PRIME VACCINATOR:

- 1.) Remove protective cover from needle.
- 2.) Align front of piston with the line of the largest dose setting. *NOTE: SOME VACCINATORS ARE FIXED-DOSE ONLY. THIS MEANS THAT THE DOSE SETTING CANNOT BE ADJUSTED (EVEN THOUGH THE ADJUSTER WILL TURN). ADJUSTABLE DOSE VACCINATORS WILL HAVE GRADUATED DOSE SETTINGS PRINTED ON THE BARREL AS SHOWN. FIXED, NON-ADJUSTABLE VACCINATORS WILL HAVE BARRELS PRINTED WITH ONE DOSE SETTING ONLY, WHICH REPRESENTS THE DOSE TO WHICH THE VACCINATOR IS FIXED. IF YOU ARE USING A FIXED-DOSE VACCINATOR SKIP THIS STEP AND GO TO STEP #3.
- 3.) Tip vaccinator up at a slight angle, with the needle pointing up, ensuring that the draw spike is below the fluid level inside the bottle. Bottles that are low on vaccine, may allow the spike out of the vaccine when tipped and allow the spike to draw air from the bottle into the barrel of the vaccinator.
- 4.) Squeeze vaccinator handle, then release quickly to draw fluid into the barrel.
- 5.) Remove any air bubbles from the barrel by repeating step 4 being careful not to waste fluid.

TO SET DOSAGE:

Align front of piston with the line of the largest dose setting using the dose adjuster. *NOTE: SOME VACCINATORS ARE FIXED-DOSE ONLY. THIS MEANS THAT THE DOSE SETTING CANNOT BE ADJUSTED (EVEN THOUGH THE ADJUSTER WILL TURN). ADJUSTABLE DOSE VACCINATORS WILL HAVE GRADUATED DOSE SETTINGS PRINTED ON THE BARREL AS SHOWN. FIXED, NON-ADJUSTABLE VACCINATORS WILL HAVE BARRELS PRINTED WITH ONE DOSE SETTING ONLY, WHICH REPRESENTS THE DOSE TO WHICH THE VACCINATOR IS FIXED.

TO ADJUST HANDLE SPRING TENSION:

*Some vaccinators are equipped with a handle spring tension adjuster as shown. If your unit is not so equipped, the handle spring tension cannot be adjusted. If so, follow these instructions for adjusting the handle spring tension.

- 1.) To increase handle spring tension, turn the knob clockwise.
- 2.) To reduce handle spring tension, turn the knob counter-clockwise until tension is relieved.

LUBRICATION:

If vaccinator becomes sluggish, clean thoroughly using the cleaning instructions on back. You may not need to disassemble the spike assembly. However, you will need to remove the barrel assembly, clean and apply a couple of drops of Prima Tech lubricant to the piston o-ring. Many times, product failure is due to insufficient cleaning (dried vaccine in valves, bung material caught in draw spike, etc.). For complete cleaning instructions, please see back panel.